

RIGHT HOME

AREA  
PENDIK

407



[RIGHTHOME.COM.TR](http://RIGHTHOME.COM.TR)

**righthome**  
real estate consultancy



## Project Overview



In this project, the door of your new home opens to profit.

The metro, which is almost in front of your home and the preparations of it are coming to an end, shopping and social areas that you can reach with an elevator, another shopping center right in front of your house and Sultanbeyli Merkez Çarşısı, a 400-bed hospital and a university to be established, transform your new home into an investment and a source of income at the same time.



## Project Overview

Your house will be under protection against all threats in this project, thanks to the 24-hour security at the entrances of the blocks and in the car park.

You don't need to wander from street to street to reach popular brands, shops and commercial units under your home will make innovations in your wardrobe and meet all your needs. You can find what you are looking for steps away from your home.

Your new home opens to a cafe and restaurants where you can spend time with pleasure and have conversations with your loved ones and to reach restaurants where you can taste world delicacies.





## Project Overview

Your children will grow up not with computers and tablets, but with games that will help their physical and mental development, thanks to the children's playgrounds under your house.

Your new home opens to spaciousness with its architecture that makes all rooms feel large and spacious, albeit in different sizes, designed to receive the sun.

The car park of each flat will safely host you, and the car park of the bazaar will host your guests safely.





## Project Site

The project located in Sultanbeyli area on the Asian side of Istanbul.

The door of your new home opens to the center of the city, with its location at the connection point of the district's transportation network, where you can easily reach Anatolia and Europe, and the metro stop that comes right in front of your door.

The distinctive location of the project in a close distance to Sabiha International Airport.

Your home will be located in a central area where all your necessities will be a few steps from you.

**TEM  
Highway**

**2**

Minutes

**Hospital**

**5**

Minutes

**Shopping  
Mall**

**3**

Minutes





# Project's Features



Elevator



Security



Parking



Available  
Transportaion





Project's  
**Photos**





Project's  
**Photos**





Project's  
**Photos**





Project's  
**Photos**





Project's  
**Photos**

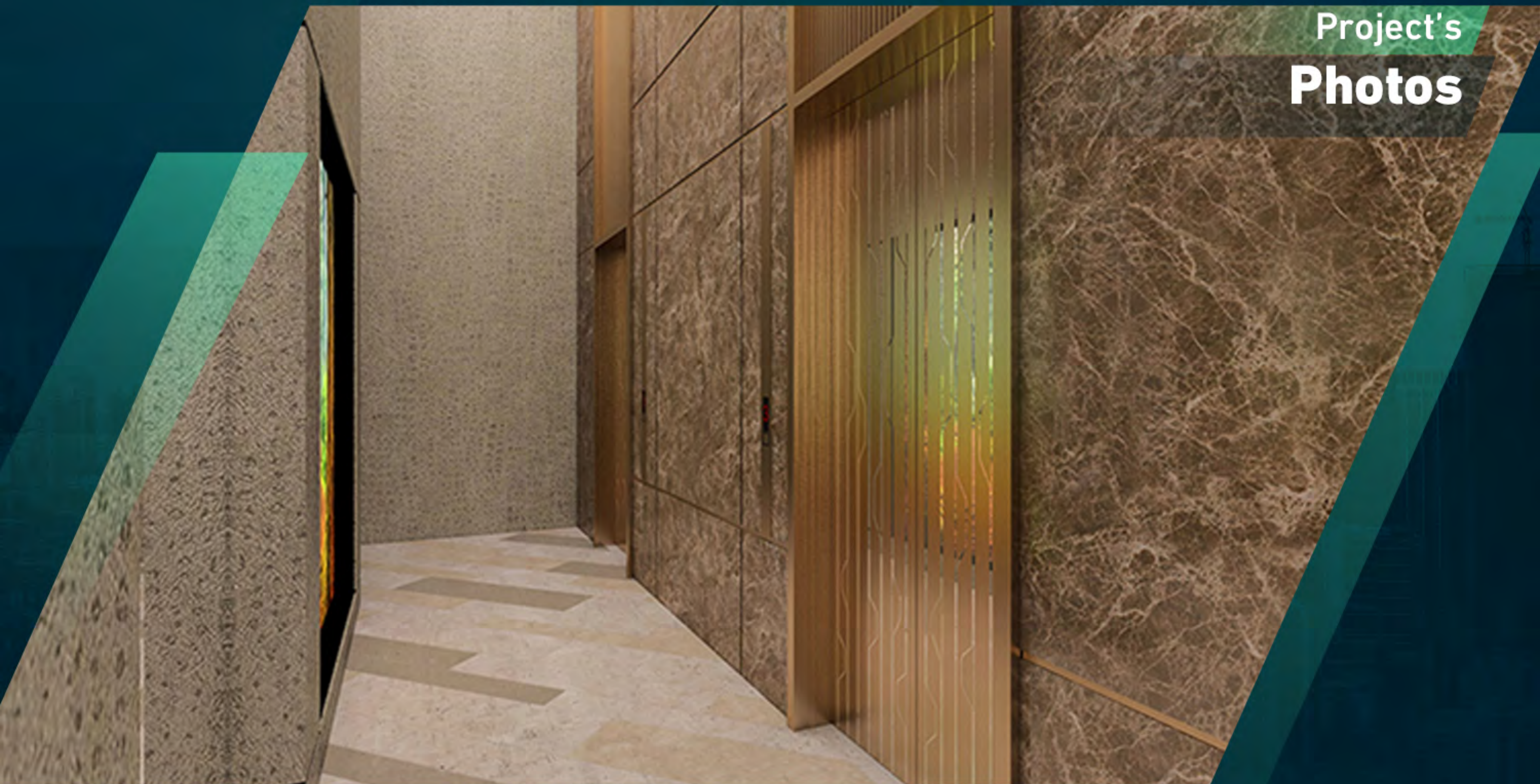



Project's  
**Photos**





Project's  
**Photos**





Project's  
**Photos**





Project's  
**Photos**





Project's  
**Photos**





About

Us

**Right Home** is a leading company specializing in real estate consultancy and brokerage.

We help buyers **to buy** and sellers **to sell**.

We provide luxury apartments, smart homes, elegantly designed offices, modern constructions and all consultancy services.

Our head office located in **Istanbul**, Turkey.

**righthome**  
real estate consultancy

 righthome\_tr  
righthome\_tr  
righthome  
righthometr  
+90 212 573 51 93  
www.righthome.com.tr  
info@righthome.com.tr