

# RIGHT HOME 154

**right**home  
real estate consultancy



It is one of the special housing projects in Istanbul, built on a land area of 28.050 square meters, 19.000 square meters of it are dedicated for green area.

The project contains 523 residences and 45 shops.

The project has a charming lake view with different apartment options ranging from 1+1 to 4+1.



The distinctive location of the project on the European side of Istanbul in Avcilar district, overlooking the Sea of Marmara on one hand and Kucukcekmece Lake on the other.

The project is close to Istanbul Canal and its location in the city center where you can easily reach all your needs such as schools, hospitals, universities, airports, shopping malls and other basic services.

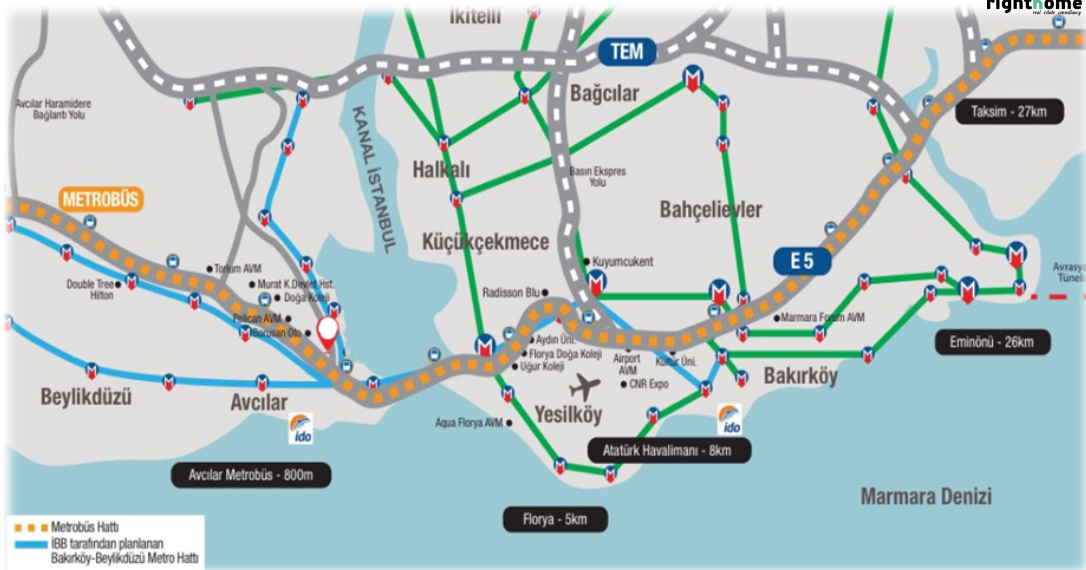





The project has social facilities that offer you the comfort and luxury life you have always dreamed of, such as a basketball court, a football court, a fully equipped gym, outdoor swimming pool, children's swimming pool, gardens, shops and famous restaurants and cafes.









Luxurious design and high-quality materials used.



# FLOOR PLANS



|                                   |                              |
|-----------------------------------|------------------------------|
| <b>Gross Area Basis For Sale:</b> | 73.18 - 73.82 m <sup>2</sup> |
| <b>Net Area + Open Balcony:</b>   | 48.01 - 48.43 m <sup>2</sup> |
| <b>Net Area:</b>                  | 43.22 - 43.65 m <sup>2</sup> |

Layout Plan



Key Plan



1+1



**Gross Area Basis For Sale:** 130.27 - 130.82 m<sup>2</sup>  
**Net Area + Open Balcony:** 88.12 - 88.49 m<sup>2</sup>  
**Net Area:** 78.29 - 78.66 m<sup>2</sup>

Layout Plan



Key Plan

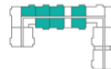

**2+1**



Layout Plan



Key Plan

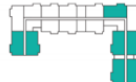

**Gross Area Basis For Sale:** 174.09 - 175.53 m<sup>2</sup>  
**Net Area + Open Balcony:** 117.76 - 118.73 m<sup>2</sup>  
**Net Area:** 107.15 - 108.12 m<sup>2</sup>

**3+1**



Layout Plan



Key Plan

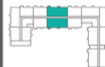

**Gross Area Basis For Sale:** 189.81 - 191.73 m<sup>2</sup>  
**Net Area + Open Balcony:** 128.39 - 129.69 m<sup>2</sup>  
**Net Area:** 122.65 - 123.95 m<sup>2</sup>

4+1

## ABOUT US

Right Home is a leading company specializing in real estate consultancy and brokerage.

We help buyers to buy and sellers to sell.

We provide luxury apartments, smart homes, elegantly designed offices, modern constructions and all consultancy services.

Our head office located in Istanbul, Turkey.

## CONTACT US

 [www.righthome.com.tr](http://www.righthome.com.tr)

 [info@righthome.com.tr](mailto:info@righthome.com.tr)

 +90 212 573 51 93

 [righthome\\_tr](https://www.instagram.com/righthome_tr)

 [righthometr](https://www.facebook.com/righthometr)

 [righthome\\_tr](https://www.twitter.com/righthome_tr)

 [righthome](https://www.youtube.com/righthome)