

RIGHT HOME

AREA  
MALTEPE

426



RIGHTHOME.COM.TR

righthome  
real estate consultancy



## Project Overview



Project area  
**7.157** M<sup>2</sup>

It is a commercial and investment project located in Maltepe area on the Asian side of Istanbul.

The project has been built and constructed by Teknik Yapi, a well-known construction company in Turkey.

The total land area of the project is 7.157 square meters.



## Project Overview

The project characterized by two modern 35-floors buildings, one office building and a second residence, the latter one can be advantageously used for starting a home business.

The residence building consists of 364 residence apartments of the types 1+1, 2+1, and 3+1, most of which are 1+1.

The project includes many facilities such as outdoor swimming pool, Turkish bath, cafeteria, gym, steam room, kids playground, and more.

The project also includes indoor and outdoor car park, reception and services entrances, emergency exit and car park entrance and exit.





## Project Overview

This project will give you the comfort you deserve with the moments you will enjoy.

With our 24/7 security services in buildings and playgrounds, your children will play safely.

Distinctive sea views starting from the 16th floor is waiting for you.

The project is under construction, and it will be ready in 2023.





## Project Site

The project is located in Maltepe area on the Asian side of Istanbul, which is one of the modern urban areas.

The project is only 200 meters from the Kadikoy-Tavsantepe metro line, which serves the Asian side of Istanbul.

The strategic location of the project directly on the E5 highway.

The special location of the project provides easy access and proximity to important points of the city.

It makes your life flow much easier with its proximity to shopping malls, hospitals, Sabiha Airport and universities.





## Project Site

Maltepe Park  
Mall

**2**

Minutes

Metro  
Station

**2**

Minutes

Canyon  
Mall

**35**

Minutes

Ikea

**5**

Minutes

Hospitals

**4**

Minutes

Metrobus

**10**

Minutes





## Project's Features



Garden



Elevator



Security



Play-  
grounds



Children's  
Playground



Swimming  
Pool



Sauna



Gym



Parking



Restaurant  
and Cafe



Turkish  
Bath



Available  
Transportaion





Project's  
**Photos**

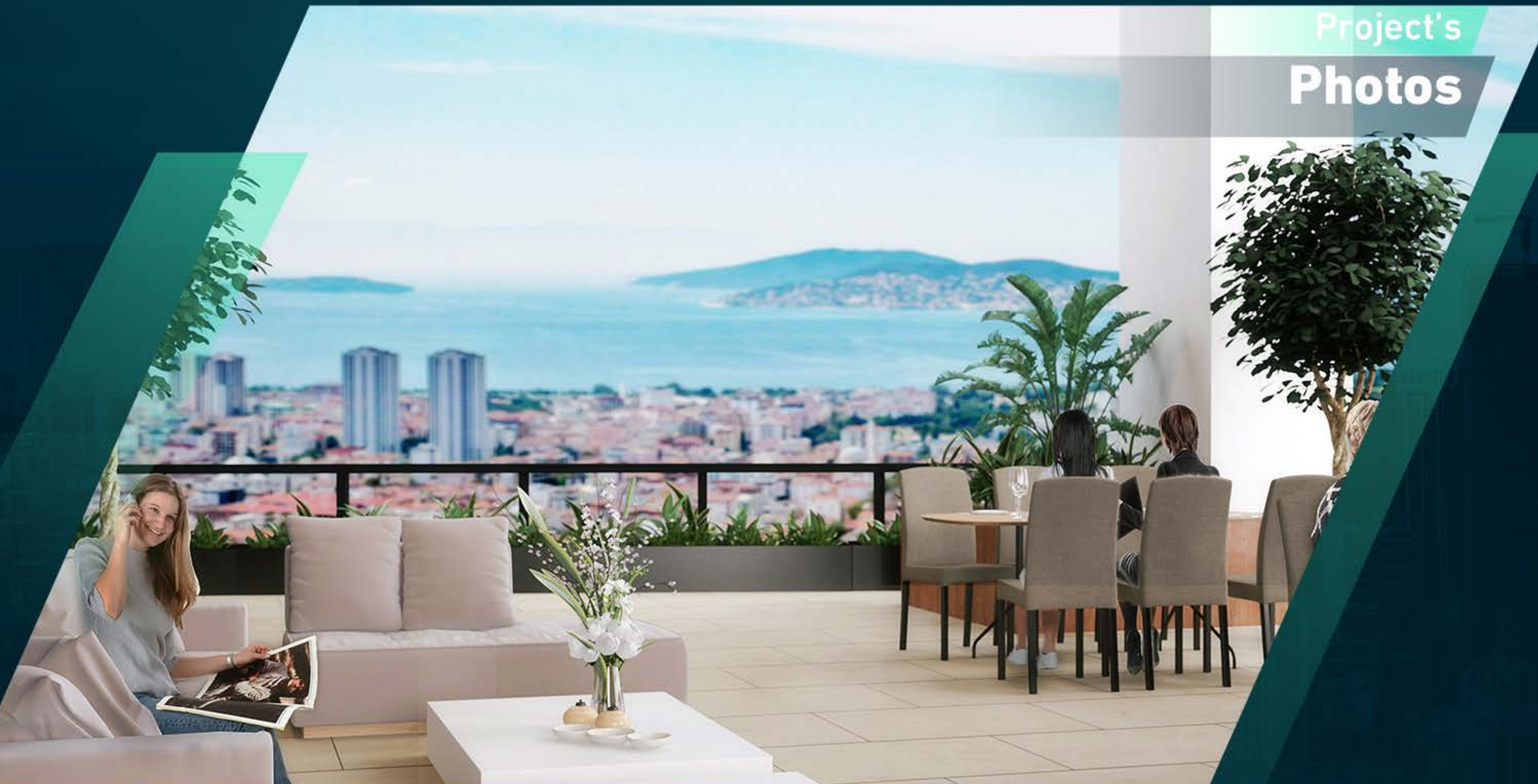



## Project's Photos





A wide-angle photograph of a modern gym interior. The space is characterized by large floor-to-ceiling windows that offer a panoramic view of a city skyline. The gym is equipped with various exercise machines, including treadmills, ellipticals, and stationary bikes. A person is visible in the background, working out on a machine. The floor is a bright yellow, and the ceiling features exposed ductwork and modern lighting fixtures. A large graphic of a dumbbell is visible on the right side of the image.





Project's  
**Photos**





# Project's Photos





Project's  
**Photos**





Project's  
**Photos**





## About Us

**Right Home** is a leading company specializing in real estate consultancy and brokerage.

We help buyers **to buy** and sellers **to sell**.

We provide luxury apartments, smart homes, elegantly designed offices, modern constructions and all consultancy services.

Our head office located in **Istanbul**, Turkey.

**righthome**  
real estate consultancy

 righthome\_tr  
 righthome\_tr  
 righthome  
 righthometr  
 +90 212 573 51 93  
 www.righthome.com.tr  
 info@righthome.com.tr