

RIGHT HOME

AREA  
KARTAL

470



[RIGHTHOME.COM.TR](https://www.righthome.com.tr)

**righthome**  
real estate consultancy

## Project Overview



The project is rising in the first parcel to the sea on Kartal coast, fascinates those who see it with its unobstructed view of the islands.

This dazzling, panoramic view of all apartments opens the doors to a peaceful home life.

These luxury apartments are built with the highest quality materials from world-famous brands.

## Project

# Overview

This luxury project, consisting of 140 prestigious residences with flat options ranging from 2+1.5 to 3+1.5, 4+1 with terrace and loft apartments, offers the opportunity of an unlimited privilege and a unique investment for a limited number of residents with its spacious houses offering high level comfort.

All houses in the project have a large and useful balcony overlooking the landscape.

The project's houses are called +1.5 thanks to this balcony, which offers you a unique balcony enjoyment when you open the folding windows, and gives you extra living space when you close it.

2+1.5 and 3+1.5 houses give you more space to live.



## Project

# Overview

It is a family-oriented project, impresses with its comfortable apartments, social areas, indoor and outdoor swimming pool and sports centre.

In this project, areas outside the home come to life with the highest quality materials and equipment.

The project has a great playground full of kids' favorite games and activities. This outdoor playground supports children's healthy development, curiosity and desire to explore.

The project also draws attention with its cafes and social areas that host pleasant conversations with your friends and neighbors.

We put socializing at the center of your life with its out-of-home areas.



## Project Site

The project located in Kartal area, on the Asian side of Istanbul.

This project, which rises on Kartal coastal road, also comes to life in a location close to E5 highway, TEM road, minibus street, metro and marmaray station and sea bus pier.

It offers easy access to Sabiha Airport and Osmangazi Bridge.

The project comes to life on the coastal road, which is famous for its lush parks, flower gardens, walking and cycling paths, jogging tracks, children's playgrounds and eating and drinking places.

The 12 km coastal road stretching from Kadikoy to Tuzla is one of the most beautiful locations in Istanbul.

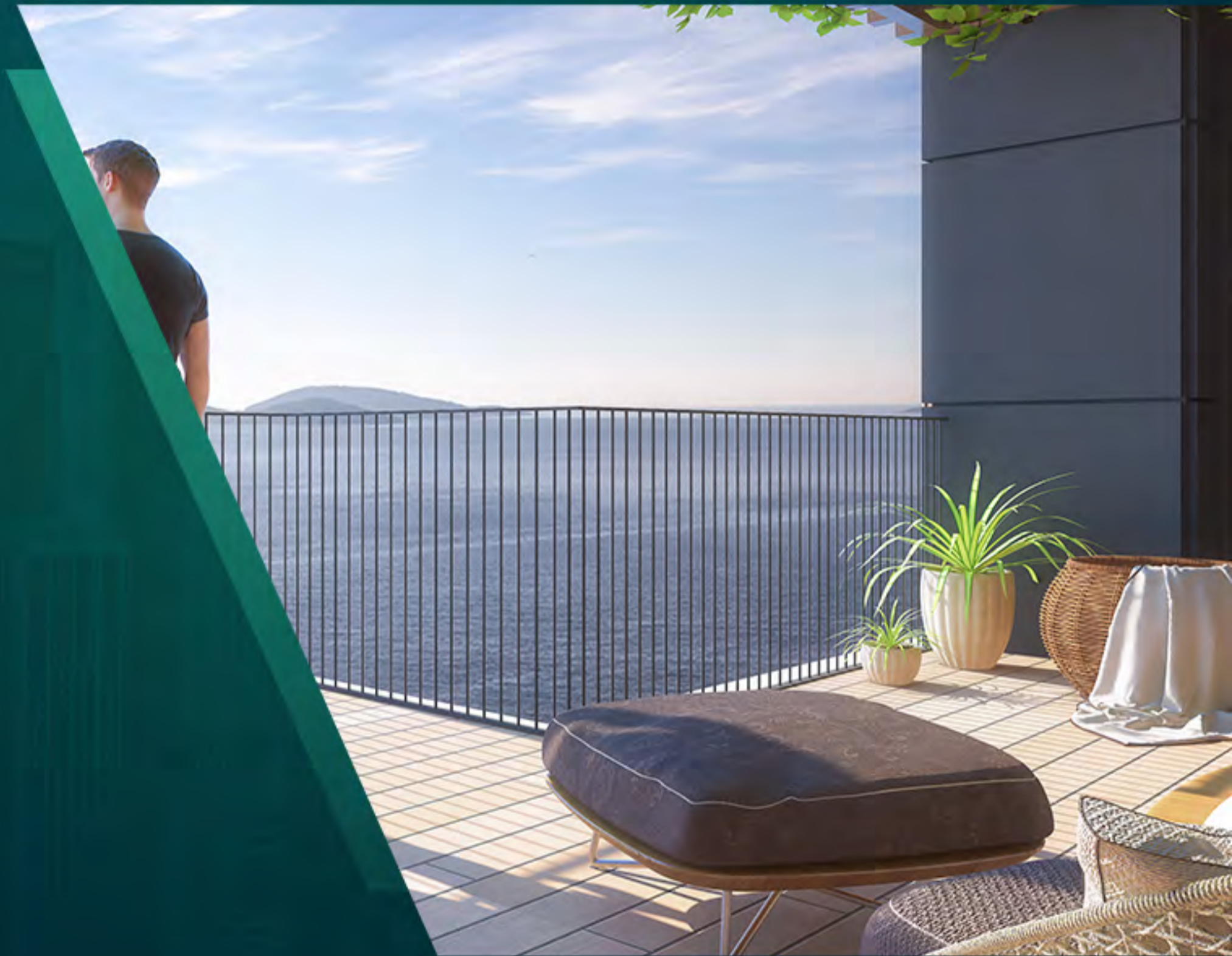

## Project Site

The project located in a privileged neighborhood where green and blue meet.

Also, this project is adjacent to the elite shopping malls, hospitals, universities and educational institutions of the Anatolian Side.

It has come to life in Kartal, one of the new business centers of Istanbul.

This unique project is located in the headquarters of national and international companies, banking bases, Pendik Marina and it is located very close to Kartal Palace of Justice.



# Project Site

Metro  
Station

**400**

meters

E5  
highway

**200**

meters

Marmaray  
metro

**10**

minutes

Maltepe piazza  
mall

**7**

minutes

Hospital

**4**

minutes

Ikea

**5**

minutes



# Project's Features



Garden



Elevator



Play-  
grounds

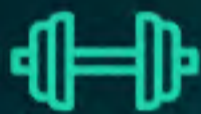

Gym



Swimming  
Pool



Sauna



Parking



Security



Turkish  
Bath





Project's  
**Photos**



Project's  
**Photos**



Project's  
**Photos**



Project's  
**Photos**



Project's  
**Photos**



About

Us

**Right Home** is a leading company specializing in real estate consultancy and brokerage.

We help buyers **to buy** and sellers **to sell**.

We provide luxury apartments, smart homes, elegantly designed offices, modern constructions and all consultancy services.

Our head office located in **Istanbul**, Turkey.

**righthome**  
real estate consultancy

 righthome\_tr  
righthome\_tr  
righthome  
righthometr  
+90 212 573 51 93  
www.righthome.com.tr  
info@righthome.com.tr